

High-functioning stool sampling sheet which catches the stool sample in midair

Raku-Ryu Cup Wide

**JAPAN
BRAND**

Patent
approved

Able to take a stool sample accurately without accidental contamination.

New generation stool sampling style which is capable of coping with a modern toilet.

High-functioning stool sampling sheet for research institution and advanced medical institution

4 features

- 01 ▶ No worry about contamination or discharge
- 02 ▶ Any type of stool can be harvested.
- 03 ▶ Stool sampling smoothly with usual posture
- 04 ▶ Less effort and hygienic / Can be flushed after use

How to set

Be able to set onto the toilet seat or toilet bowl.

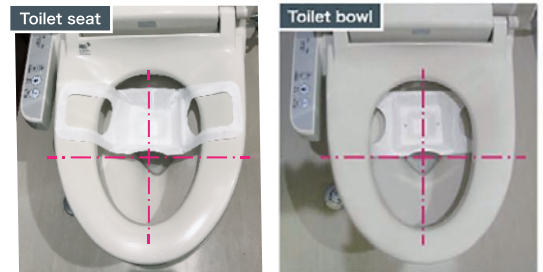

Previous problems

Problems of conventional products and Specimen Collection Pans.

- 1 Disposing of containers is laborious and unsanitary
- 2 risk of infection

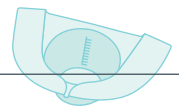

Advantages



Research institutions

- Improvement of data reliability
- Non-detection risk reduction
- Able to catch the sample



Subject / patient

- Stress reduction
- Hygienic
- Easy dealing with after use



Medical Organization

- Improvement of patient service
- Infection risk reduction
- Disposal cost reduction

Product structure

Original shape with high strength

Discharge excess water and urine

Bridge structure with high stability

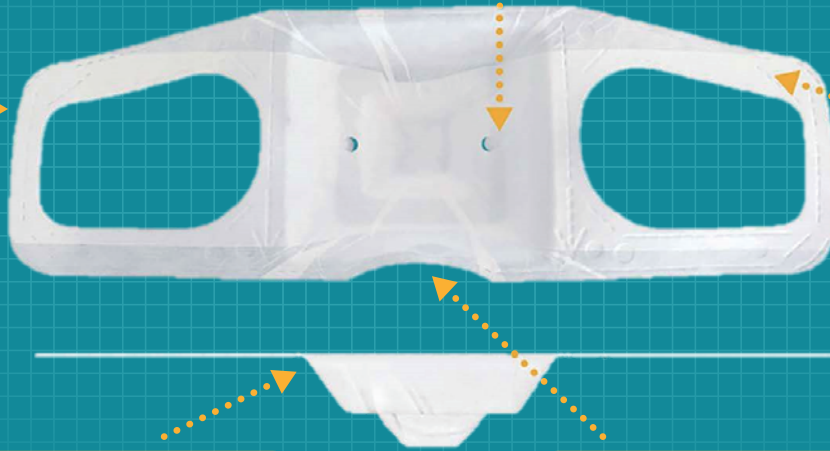

Be sure to catch the sample with its 3D shape

Reduce the chance of urine mix with stool sample

► Tins product is superior in collect and dispose

- It has excellent durability; the weight limit is more than 1kg.
- Provided by own patented technic
- Water disintegrable - which approved by specialized inspection institute



【 Toilet excretory test 】

Condition for use: φ50mm pipe (Japanese standard φ70 ~ 100mm) Water quantity 4L (water saving toilet)

Paper used for "Raku-Ryu Cup Wide"

is passed the Water disintegrable standard of Europe which has strict environmental measure standard.

How to use

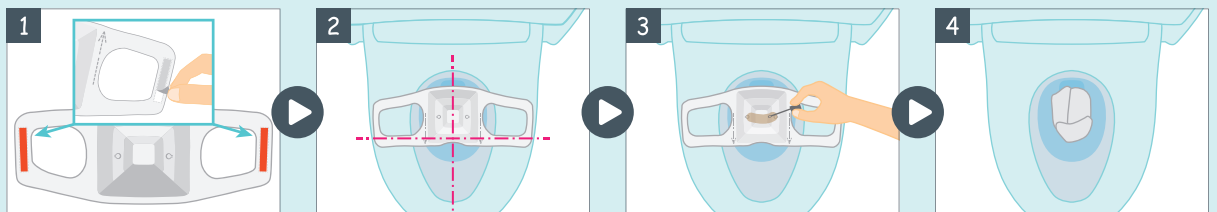

- 1 Peel the paper lining from the double-sided tape.
- 2 Affix the to the seat position back side of the toilet seat. It can also affix to the toilet bowl.
- 3 After toilet use, take a stool sample.
- 4 Remove from the toilet seat and flush.

Catalog part number

Fold | RCW20-0

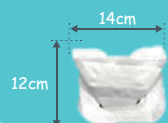

Sizes

- Length/approx. 12cm
- Width/approx. 14cm

Non-fold | RCW2-0

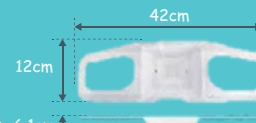

Sizes

- Length/approx. 12cm
- Width/approx. 42cm
- Height/approx. 6.1cm

Contact

DENIS
MAISON FONDÉE EN 1862



DENIS PHARMA K.K.

TEL: +81-3-5510-2932

FAX: +81-3-5510-0130

Email: info@denispharma.jp